

# Location: 1350 E Street SE | Becker's Park

Corner of E Street SE and Carry's Way SE

The space is ideally located, as it doesn't share any walls with any other tenants. Main acoustic separation is the floor above.



Board of Zoning Adjustment  
District of Columbia  
CASE NO.20705  
EXHIBIT NO.25A

# Preliminary Floor Plan (subject to change)

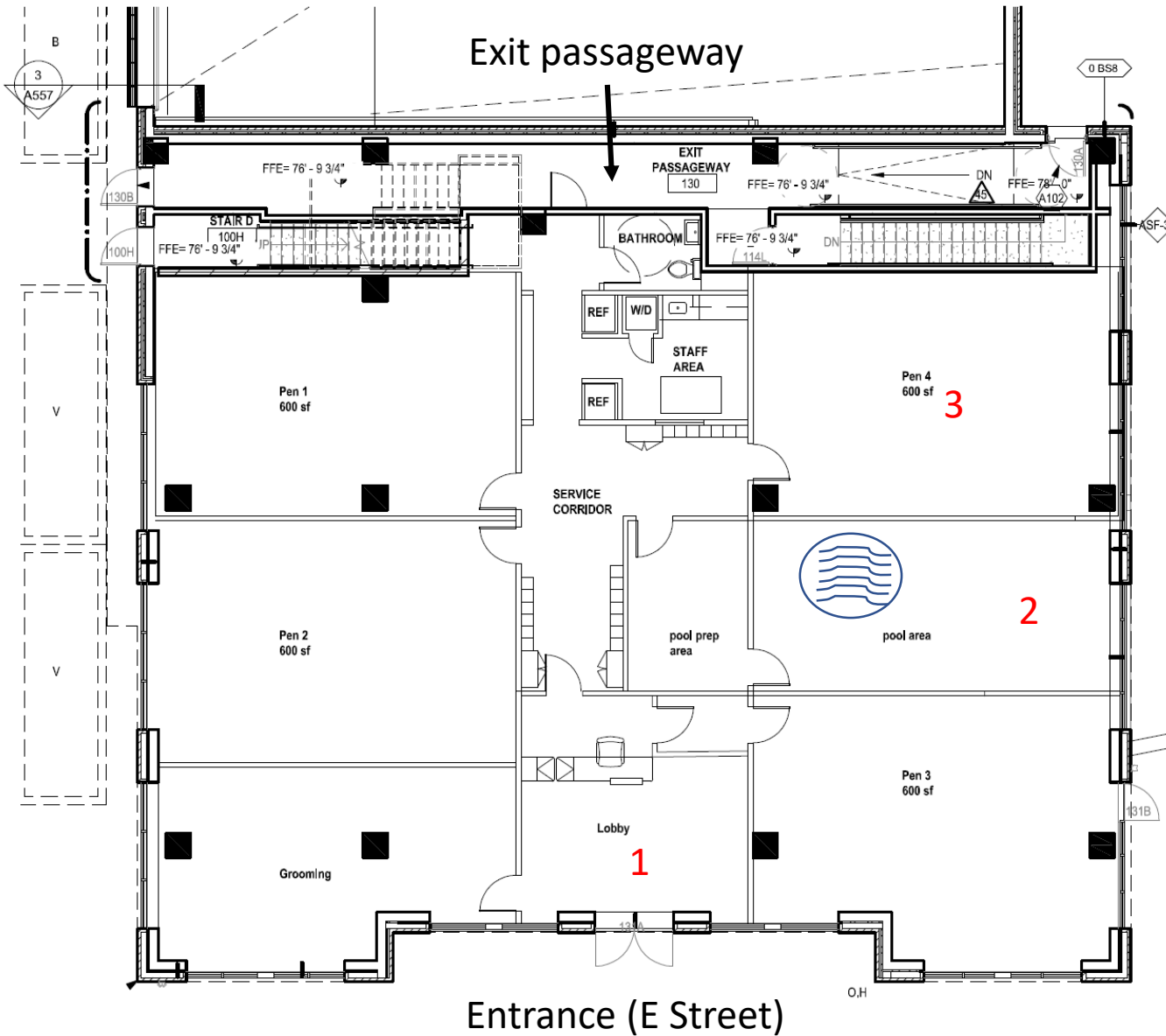

- 1. Lobby:** Dog pens and lobby separated by a minimum of 3 sets of doors to prevent runaway dogs.
- 2. Proposed pool area:** Applicant is considering shallow pool for therapeutic purposes, based on input from engineer.
- 3. Smell:** Each pen has dedicated drains and “pee pads”. The pens will be cleaned on a consistent basis with vet-grade products and will have dedicated cleaning closets. Green walls and dedicated ventilation system will function to remove/mitigate unpleasant odors.
- 4. Sound proofing:** Only adjacent tenants are above. Proper soundproofing will be installed with acoustic separation to meet decibel requirements.

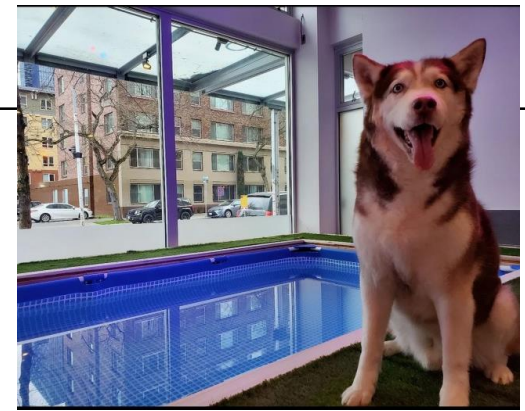

# Lobby Area Design Standards

Example at Bethesda location: high quality-materials and designs to create an inviting environment for both pets and owners.

